

DEVALOKE SONARCITY PROJECT:

LOCATION MAP:

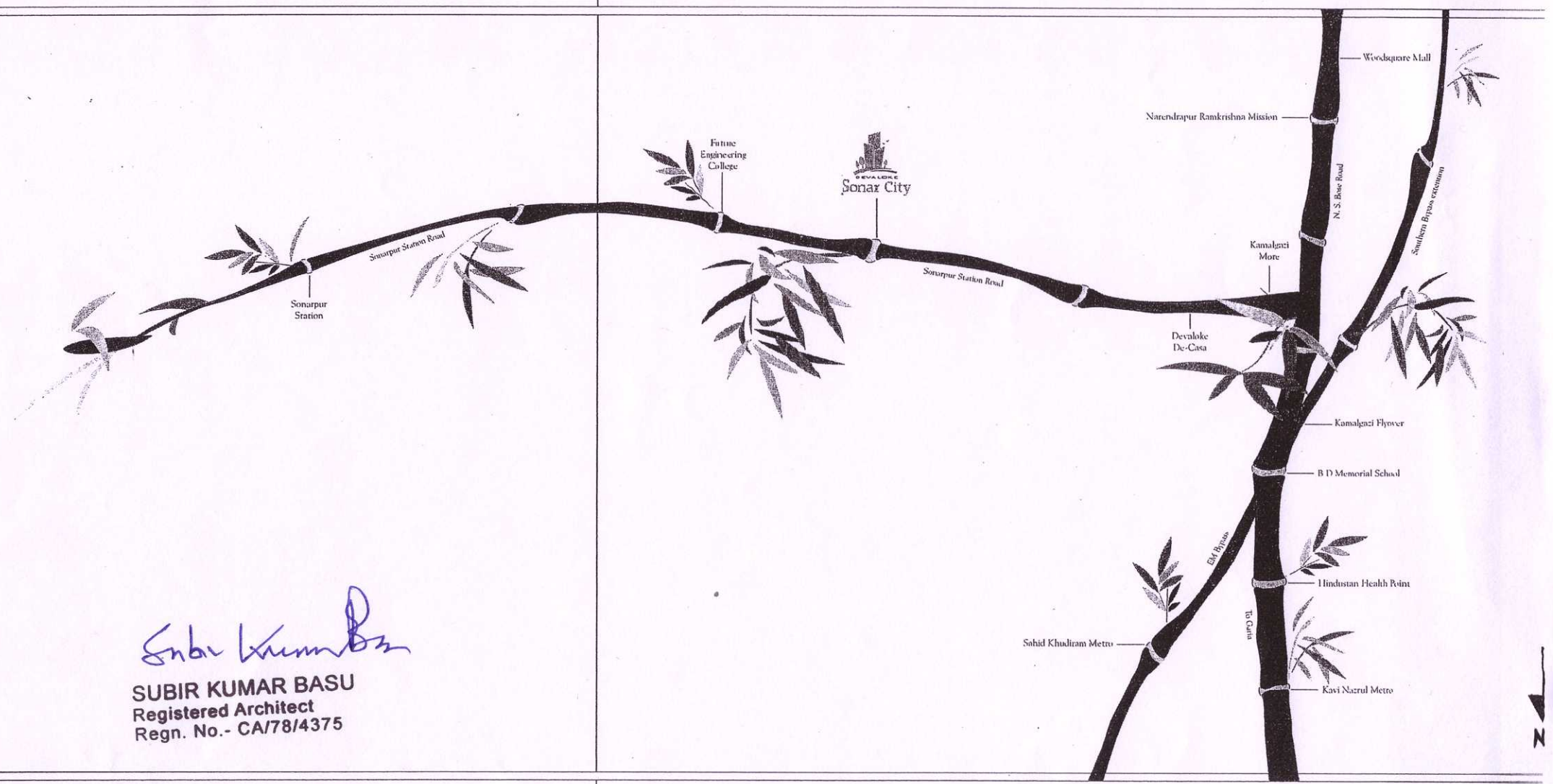

*Subir Kumar Basu*  
**SUBIR KUMAR BASU**  
Registered Architect  
Regn. No.- CA/78/4375

**LAND PROFILE**  
OF  
**"SONAR CITY"**  
Holding No.-1117, Shimulata,  
Sonarpur Station Road, Kolkata - 700150  
SCALE : 1cm. = 20.00m.

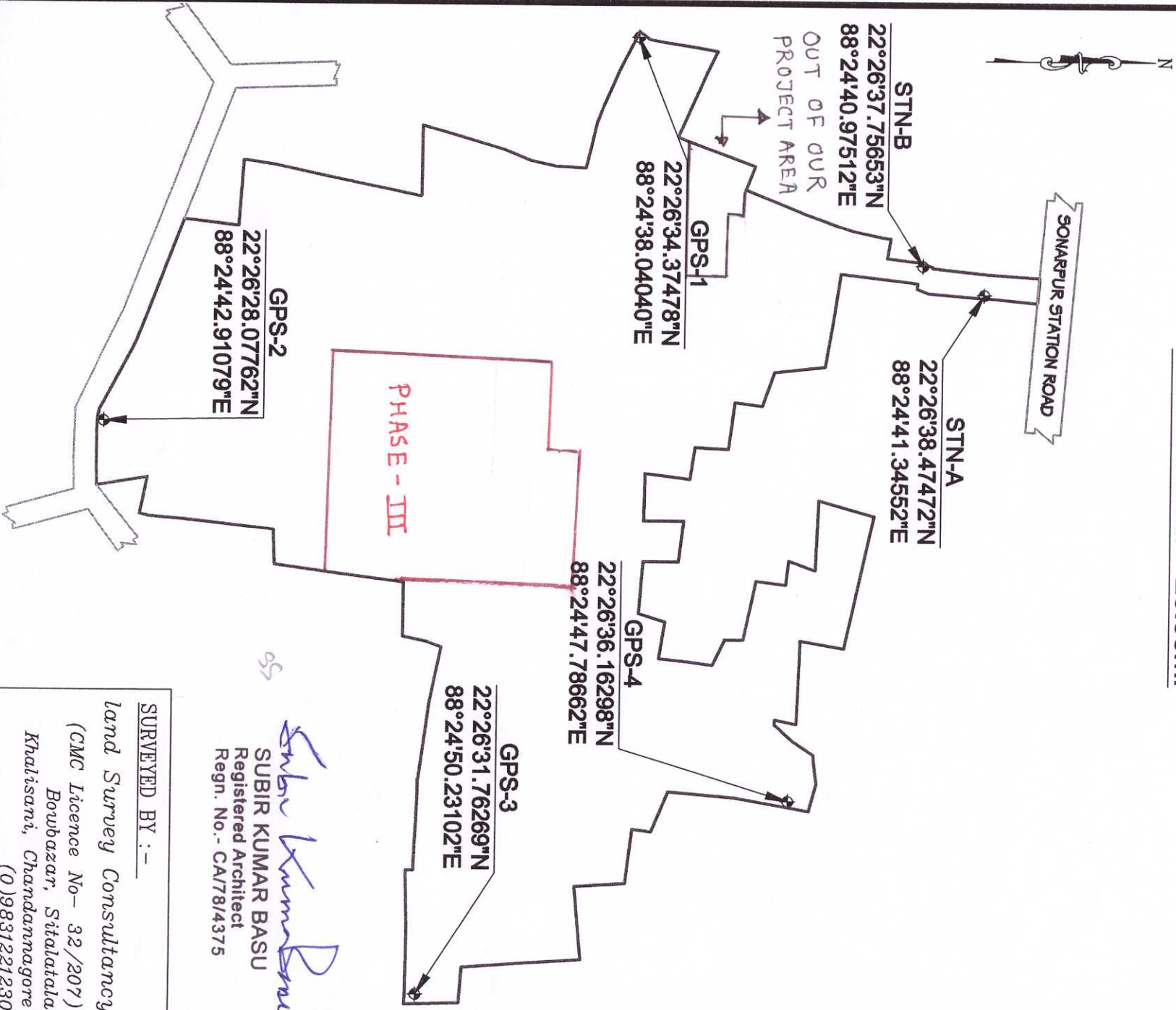

*SUBIR KUMAR BASU*  
SUBIR KUMAR BASU  
Registered Architect  
Regn. No. - CA/78/4375

SURVEYED BY :-  
land Survey Consultancy  
(CMC Licence No- 32/207)  
Bowbazar, Sitalata  
Khalisani, Chandanmagore  
(0)9831221230  
landsc@rediffmail.com